

Anna Leonowens Gallery

1891 Granville St Halifax NS



Anna's notes:

- All walls are constructed from gyproc wall board over wood base and finished with semi-gloss white latex.
- All floors are constructed in wood and finished in grey gloss enamel.
- Two moveable walls are available.
- Air Conditioning in galleries 1 & 2.
- Ceiling fans in all galleries.
- Kitchen facility in basement.
- Gallery is monitored by video surveillance
- The gallery is occupied within historic buildings, therefore the walls and floors may not be level.
- All measurements made by a human, remeasure the space for exact dimensions.

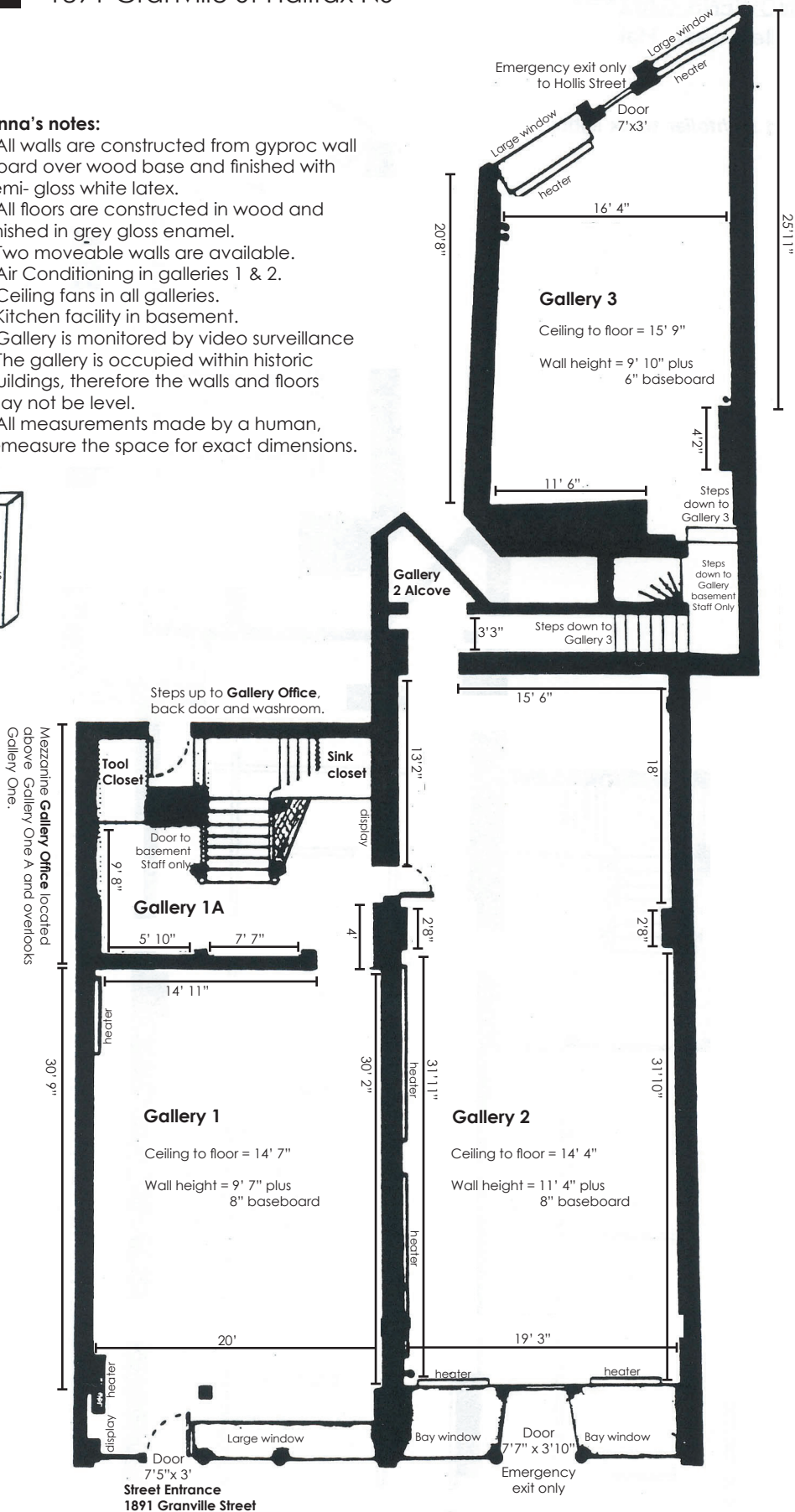
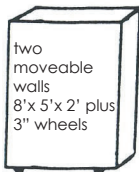

Street Entrance
1891 Granville Street